

TurboV™ Source Electrodes and Column Heater Assembly

Quick Start Guide

5017432 A

Part Number	Description	Detail
5016411	50 Micron ESI Electrode	Electrode for AB SCIEX Turbo V Source (50 µm ID)
5016874	25 Micron ESI Electrode	Electrode for AB SCIEX Turbo V Source (25 µm ID)
5016941	Kit, Grounding, Electrode to Source	Grounding kit for AB SCIEX Turbo V electrodes (5016411 & 5016874)
5015996	Assy, Mounting, HT Column Oven	Clamp and Rod Assembly, mounting for HT column oven



25 µm ID (top) and 50 µm ID (bottom) hybrid electrodes – made of PEEKsil, with a 1 cm stainless steel tip

A. Recommended flow rate ranges:

Recommended flow rate range -50 µm ID electrode	20-200 µL/min
Recommended flow rate range - 25 µm ID electrode	5-50 µL/min

B. Using the Electrodes & Clamp/Column Heater Assembly:

- 1) Use the 50 and 25 µm ID electrodes with the standard Turbo V™ probe. Make sure to use with the longer spring that comes with the electrode as shown (replace the spring used with the larger ID electrodes).
- 2) Insert the electrode into the central shaft of Turbo V probe as you would the standard larger ID TurboV electrode or the 65 µm ID electrode.
- 3) Tighten the black screw cap on the Turbo V probe and adjust to extend the electrode tip 1-2 mm past the probe tip as with the standard larger ID electrodes.

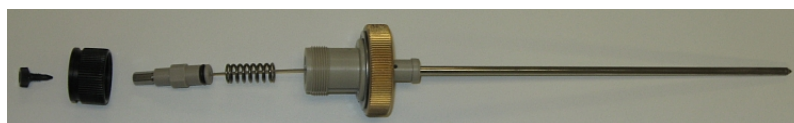

Top of electrode showing long spring inserted into the standard TurboV™ Source probe

Clamps, Grounding and Column Oven Support Kit:

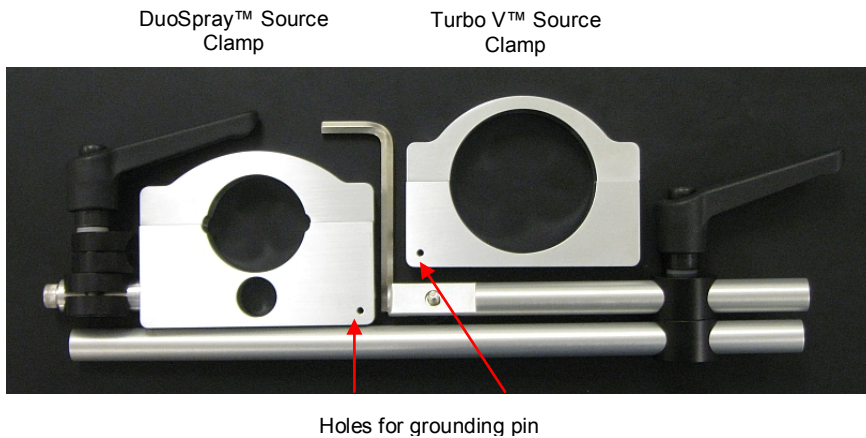

- 1) Attach the two-piece clamp onto tower of TurboV™ or DuoSpray™ source as shown. Note that the ring cutout on the inside of the clamp rests on a specific ring of the Turbo V source tower (see picture).
- 2) The lower rings on Turbo V tower have a slightly larger diameter than upper rings.
- 3) Rest the inner edge of the clamp on the ring shown.
- 4) Use the ring with the hole or thick ring for reference.
- 5) For the DuoSpray source, set vertical caliper to 0 and lower front half of the clamp over caliper knob as shown.
- 6) Attach rod assembly to clamp.

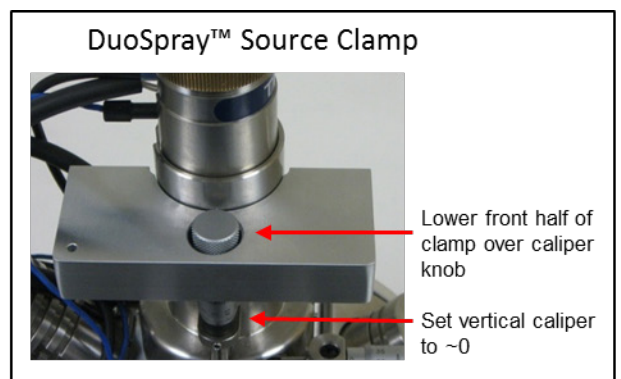
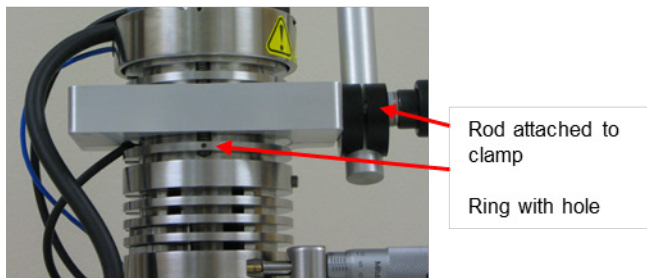
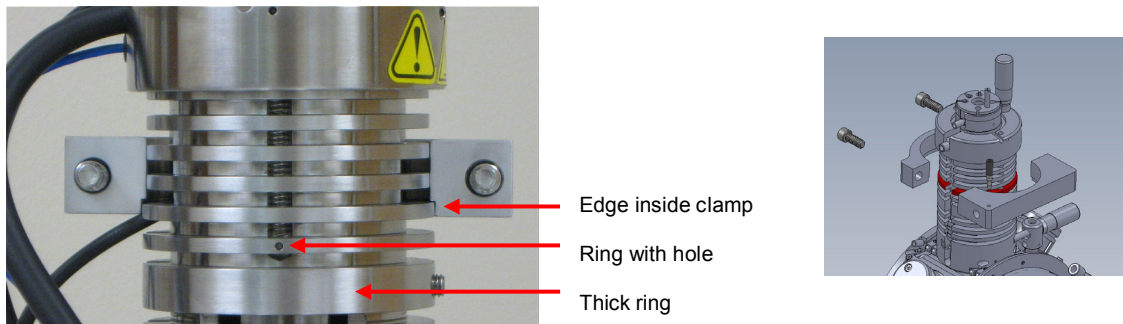

- 7) Assemble rods and clamp as shown.
- 8) The black clamp handles can be pulled out to rotate freely by pushing on center button.

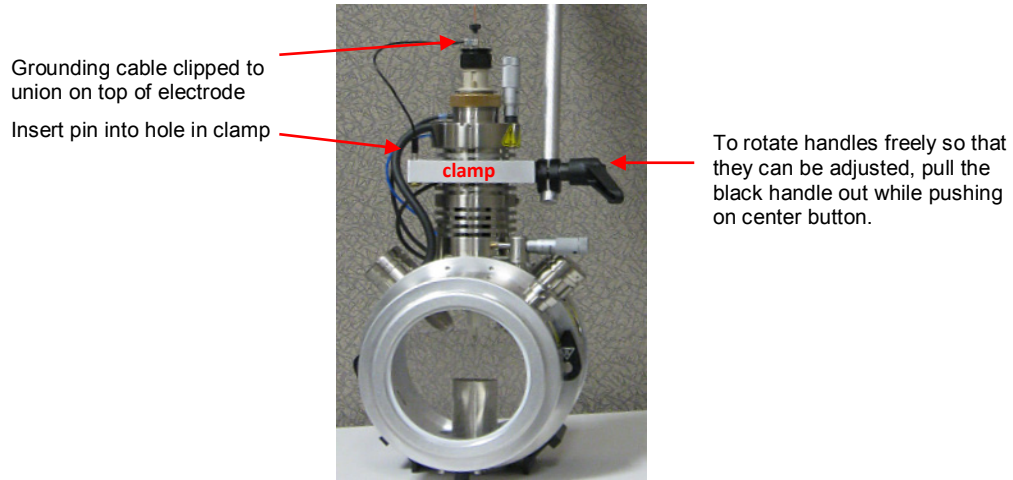

- 9) Clip the grounding cable to union on the top of the electrode on one end and then insert the pin in the hole on the clamp to ground the electrode.
- 10) If the clamp and rod assembly is not available or not being used, use the longer length grounding cable with pin inserted into the large square clip and clip the cable directly to the slots in the source housing, securing with the screw on the clip.

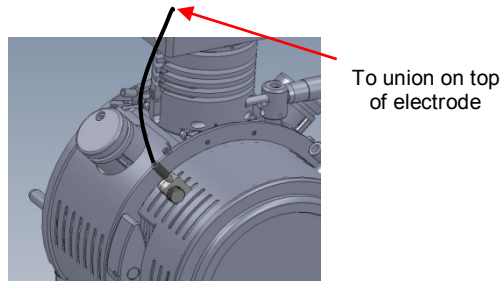

- 11) To attach rod clamp to the column oven, follow the three steps shown:
 - a. loosen thumbscrew and remove black clamp plate from the rear of oven
 - b. set black clamp plate aside (this will not be used)
 - c. place rod clamp on rear of oven and secure with screw



12) Connect column heater with tubing (50 μm ID PEEKsil recommended for 1.0 and 0.5 mm ID columns; 25-30 μm ID PEEKsil recommended for 0.3mm ID columns) post-column to top of electrode to complete the assembly as shown (remember, the black handles can be pulled out and rotated freely by pushing in the center button). Vertical mount (e.g for the AB SCIEX QTRAP[®] 5500 system) is shown below on the left, and the horizontal mount (e.g. for the AB SCIEX 4000 QTRAP[®] system or AB SCIEX TripleTOF[™] 5600 system) is shown on the right.



Example improvements in resolution

